



KDL Tiny Homes

Gate 4, 120 Foundry Road, Silverdale
Mobile 021 034 2363 Office 0800 245 561



Web: kdltinyhomes.co.nz

Email: kdltinyhomes@xtra.co.nz



REF: KDL2

18 m² (approx)

Built by Licensed Builder

Orders being taken now - a 30% deposit secures your tiny home

- Cabin with kitchenette and sink with cold water
- Internal wall for shower room or storage
- Bathroom fixtures are not included or upgrade to KDL3 to include a shower room..
- External cladding – painted shadowclad in your choice of colour
- Steel roof in Grey Friars or Ironsand
- 32 amp caravan connection
- Internal wall lining - 9 mm ply or V groove mdf
- Ceiling – 9 mm ply or mdf
- Fully insulated floor, walls and roof
- 7 x double power points, 1 x external power point
- 3 x internal recessed lights & 1 x external light
- Double glazed aluminium French door
- 2 x aluminium double glazed windows

We custom build quality portable homes to suit all your accommodation needs.
Contact us today so we can make your Tiny Home vision a reality!

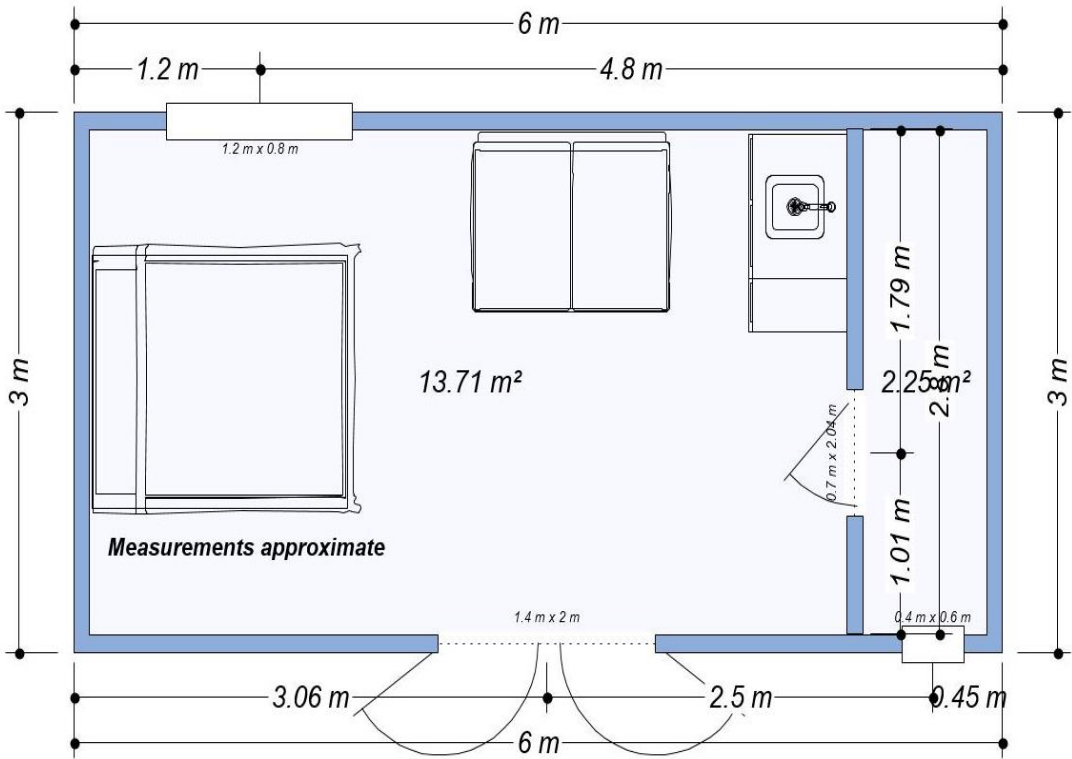

REF: KDL2



Plans are for illustrative purposes only

Add a road legal trailer as an optional extra. Electrical certificate supplied. Price does not include delivery